

NOTE:
 1. DIMENSIONS AND NOTES ON THIS DRAWING SUPERSEDE TITLE BLOCK
 2. ALUMINUM ASSOCIATION STANDARD TOLERANCES APPLY FOR EXTRUSION PROFILE.
 3. ALL DIMENSIONAL LIMITS APPLY BEFORE COATING, I.E. PAINT COAT OR ANODIZE COAT.

REVISION HISTORY				
REV	DESCRIPTION	ECN #	MFG APPRO	DATE
0				

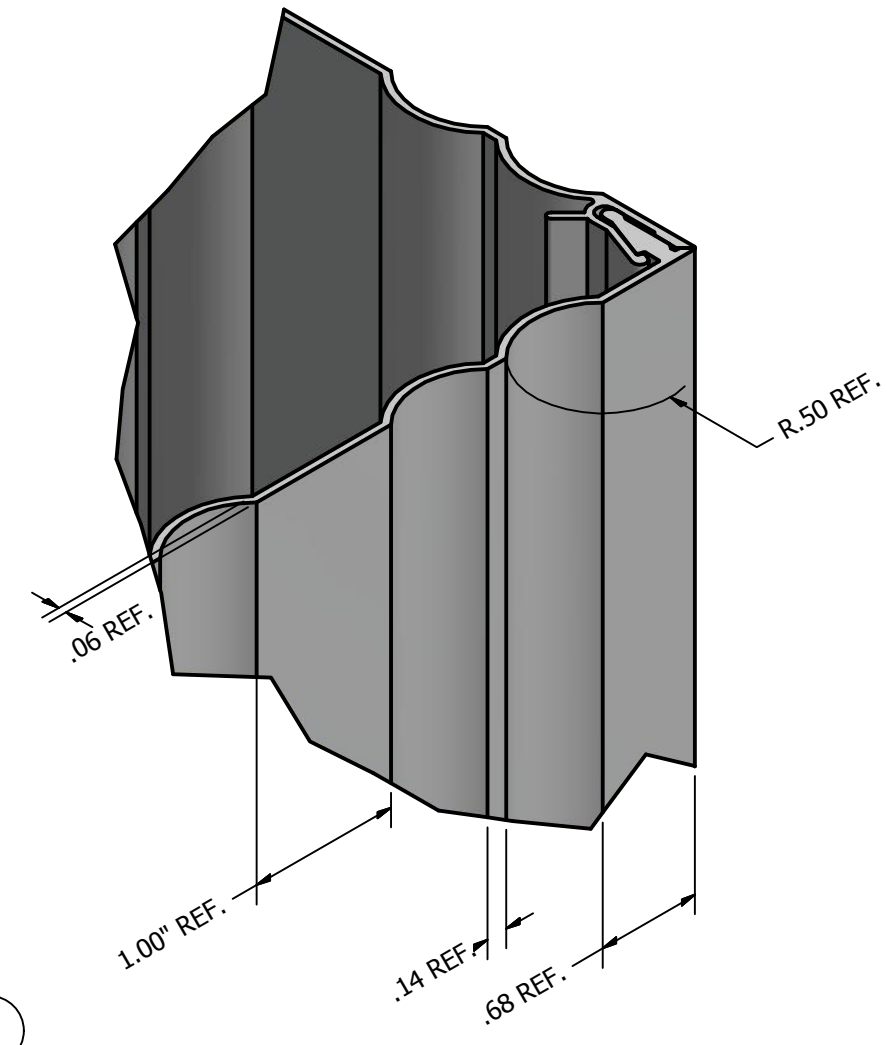

DETAIL A
SCALE 1

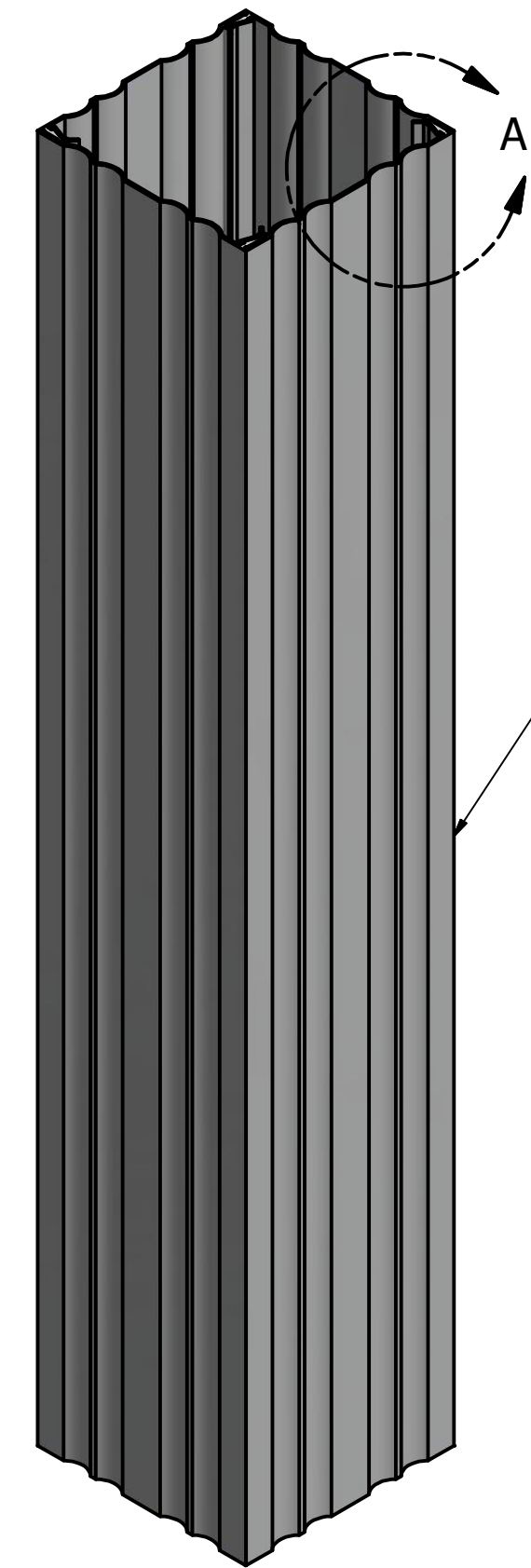
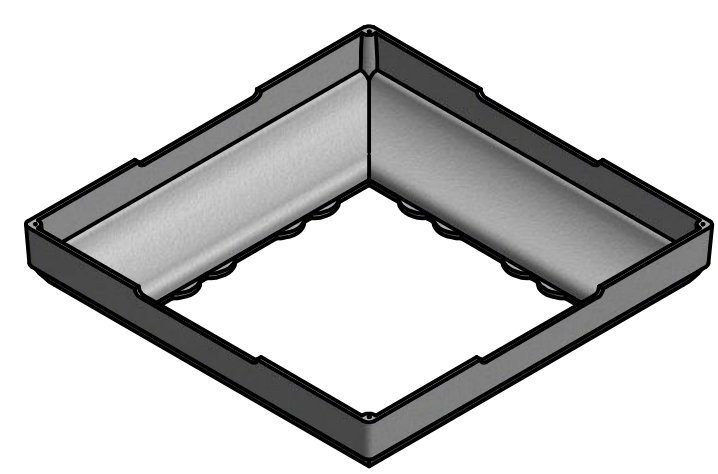
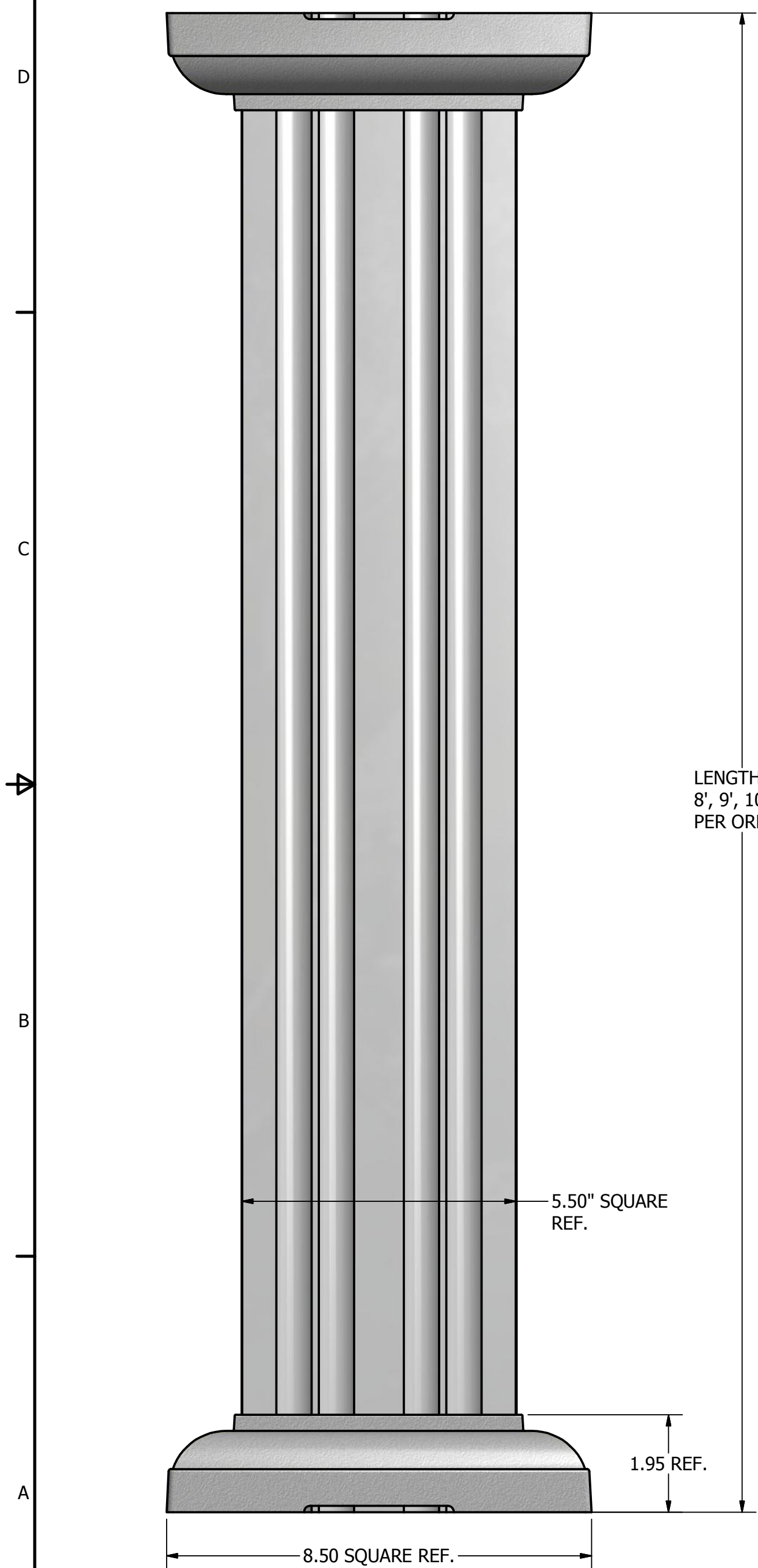
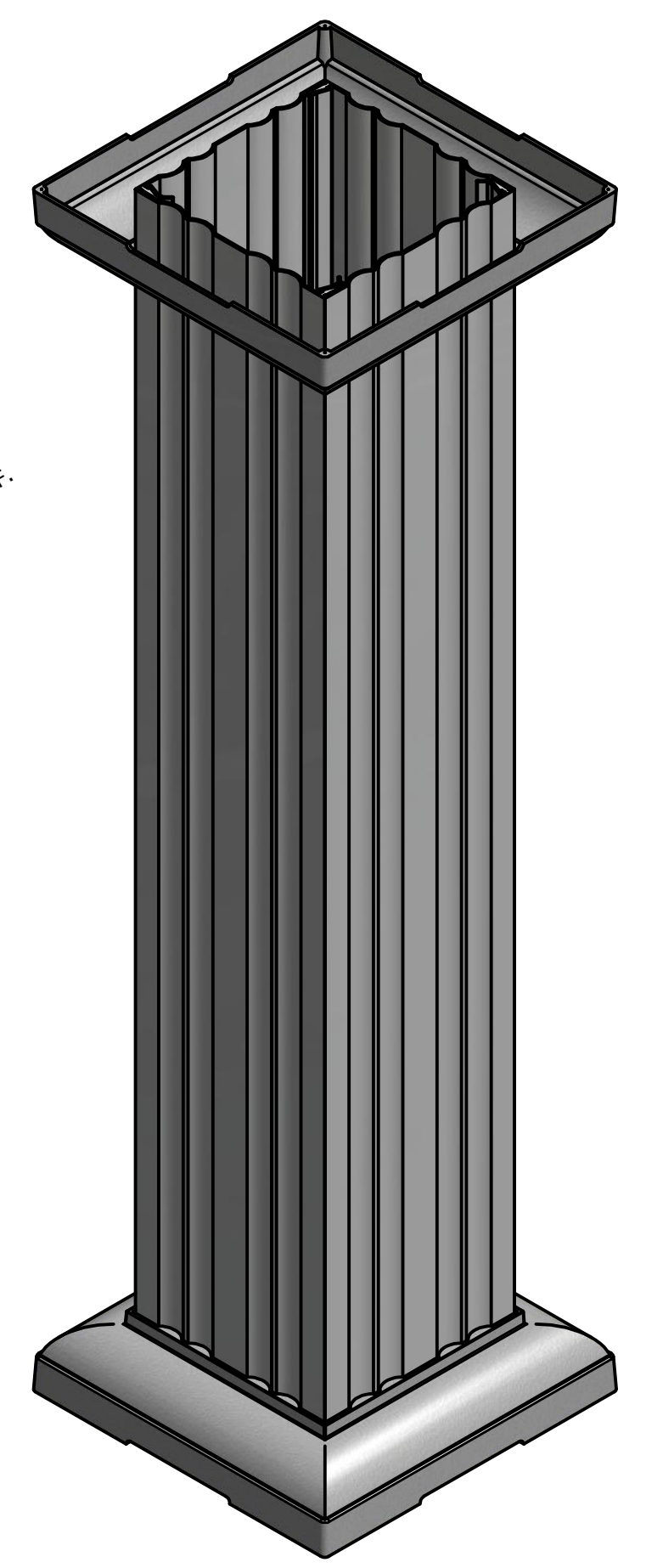

ISOMETRIC VIEW

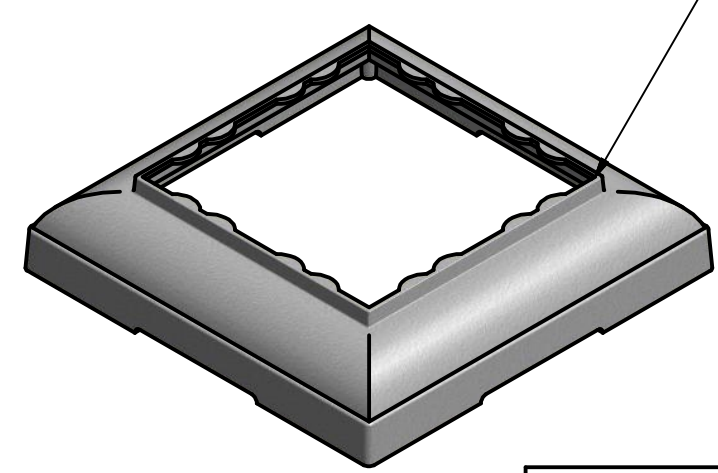

UNCONTROLLED COPY
FOR REFERENCE ONLY
DATE: 11-14-2013

NOTE FOR 6" SQUARE COLUMN:
MATERIAL EXT. DIE AF-4439

PARTS LIST		
ITEM	QTY	DESCRIPTION
1	1	6" SQUARE COLUMN
2	2	6" SQUARE CAP&BASE

DRAWN BY: DHLE	DATE: 11/14/2013
FINISH: PAINTED	
MASS: N/A	
MATERIAL: AL ALLOY SER.6000	
ITEM CODE: NA	
LENGTH: VAR. 8'-10'	
CAD FILE: ENG/6" SQ COL/...	

Worthington Millwork		
CUSTOMER: AFCO ALUMINUM COLUMN PRODUCTS		
PART NAME: 6" SQ ALUM COL ASSY		
SIZE C	DRAWING NO.: 6" SQ. ALUM COL ASSY	REV. 0
DO NOT SCALE DRAWING		SHEET 1 OF 1

DIMENSIONS ARE IN INCHES.
ALUMINUM ASSOCIATION STANDARD TOLERANCES APPLY FOR EXTRUSION PROFILE ONLY. UNLESS OTHERWISE SPECIFIED, FAB DIMS TOLERANCES ARE:
 FRACTIONAL: $\pm \frac{1}{32}$ "; ANGULARITY: $\pm 1'$
 [.XXX : $\pm .020$] [.XX : $\pm .031$] [.X : $\pm .063$]

THE INFORMATION CONTAINED IN THIS DRAWING IS THE SOLE PROPERTY OF WORTHINGTON ANY REPRODUCTION IN PART OR WHOLE WITHOUT THE WRITTEN PERMISSION OF WORTHINGTON IS PROHIBITED.